

TYPE – A direct, unvented, high-temperature water storage tank designed to operate with a remote heat source. It is approved to Australian Standard AS3498.

HOW IT WORKS - The **SV Series** stores potable, consumable water. This water is heated remotely from the tank by either a Heatmate or HEV gas heater. Cold water from the bottom of the storage tank is circulated by a pump (inbuilt in the Heatmate) to the remote heater. As water flows through the remote heater it is heated and returned to the bottom of the storage tank. This cycle continues until all the water in the storage tank has been heated. A thermostat sensor located near the bottom of the storage tank monitors the temperature of the water and when it has reached the set-point it turns the pump off. This in turn stops the flow of water through the heater and the heater goes to stand-by. When the temperature falls in the tank, the heating cycle begins again.

STORAGE TANK – Is constructed from mild steel, which is vitreous-enamel-lined to withstand high-water temperatures of up to 82°C on a continual basis. An industry high water delivery of 90% of the storage capacity is achieved because water circulation and displacement are combined.

BURNER – a Rheem Continuous Flow unit, Heatmate or HEV series water heater can be connected to the storage tank depending on the application. The heater heats the stored, potable water and continues to reheat it until the thermostat set point is achieved.

INSULATION – High-density polyurethane (CFC free) foam is injected into the outer casing for total cylinder coverage.

CASING – is constructed of durable, 0.4mm Colorbond® that is suitable for both internal and external use.

WATER QUALITY –

Acceptable range:

Refer to the standard warranty conditions available from an Edwards' representative.



(Photo supplied by Sola Edwards Adelaide)

FLUING – Any water heater connected to the SV Storage tank must comply with Australian Standard AS5601 and any relevant local regulations.

HOT WATER PLUMBING – It is good practice to insulate pipework to reduce heat loss.

COLD WATER PLUMBING – The minimum valving required prior to the heater is a stopcock, non-return valve and a cold-water expansion control valve set at 700kPa. A line strainer is recommended. Where incoming water pressure exceeds 550kPa, a pressure-limiting valve set at 450kPa must be fitted prior to the non-return valve (refer AS3500.1 and 3500.4). The SV series is classified as a low hazard system and requires the appropriate backflow prevention device.

RELIEF VALVES – Each cylinder must be fitted with a 700kPa cold-water expansion control valve and an 850kPa/99°C pressure/temperature relief valve. Any heat source must have its own energy valve fitted to suit its kW rating.

SOLAR PRE-HEATER – An SV tank can be connected to a bank of solar panels to pre-heat the incoming cold water to the system. This involves cold water being drawn from the bottom of the tank and circulated through the solar collectors by a pump.

DIMENSIONS

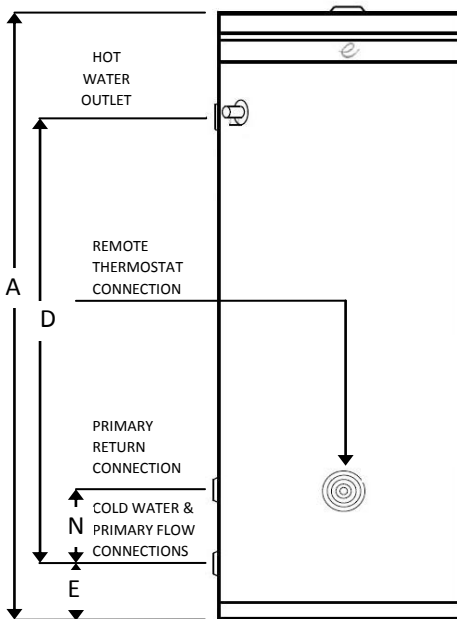

CLEARANCES

TOP	=	150 mm
FRONT	=	900 mm
SIDE	=	100 mm
BACK	=	100 mm

CONNECTIONS

HOT WATER OUTLET	=	50mm
BURNER/PRIMARY RETURN	=	50mm
COLD WATER INLET & PRIMARY FLOW	=	50mm

DIMENSIONS AND TECHNICAL DATA TABLE

Model Number		SV325	SV410	
Storage Capacity		Litres	325	410
Dimensions	A	mm	1640	1835
	B	mm	640	685
	C	mm	640	685
	D	mm	1298	1482
	E	mm	115	108
	H	Degrees	32°	30°
	J	Degrees	90°	84°
	N	mm	290	273
Weight Empty		kg	87	111
Inlet/Outlet Connections			RP2/50	RP2/50
T & PR Valve Connection			RP 3/4 /20	RP 3/4 /20
Remote Thermostat Connection			RP 1/2 /15	RP 1/2 /15
T & PR Valve Setting		kPa	1000	1000
Expansion Control Valve (EVC)* Setting		kPa	850	850
Maximum Water Supply Pressure				
• Without ECV* fitted		kPa	800	800
• With ECV* fitted		kPa	680	680
Maximum Stored Water Temperature		°C	82	82
Manifold – Min Centre to Centre		mm	890	935

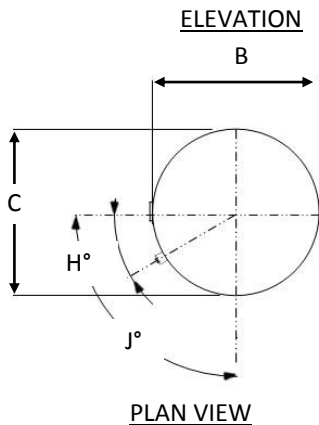

Tanks may be connected in parallel for greater versatility and output

NOTE: heater outputs calculated on a cold inlet temperature of 15°C

Care has been taken to ensure that all information is as accurate as possible at the time of publication. However, specifications, methods and figures are subject to change without prior notice.

DISTRIBUTOR:



For more information
 Call Sales 1300 132 949 (Australia only)
 Call Service 1300 132 948 (Australia only)



Edwards Commercial Hot Water
 39 Koornang Road, Scoresby, Victoria 3179
 A division of Rheem Australia Pty Ltd ABN 21 098 823 511

Ph 61 (3) 9757 3333 – Fax 61 (3) 9757 3380
 website: www.edwards.com.au
 email: info@edwards.com.au

ETDS-SV-VER2-050109